

# Crown Centelleo



CROWNREALTY

We deliver more than we commit



✉ [rcrown.realty@gmail.com](mailto:rcrown.realty@gmail.com) 🌐 [www.crownrealty.in](http://www.crownrealty.in)

☎ Call : +91 98360 52595 / 79805 34431 / 98753 38028

Front  
**Day** View



Front  
**Night View**





# Typical Floor Plan



Flat Type	BHK	Super Built-up Area (Sq ft)
A	3	1415
B	4	1569
C	2	911
D	2	1098
E	2	1105

# Flat - A

Super Built-up Area-1415 Sq ft  
3 BHK



Flat - A Key Plan



# Flat - B

Super Built-up Area-1569 Sq ft  
**4BHK**



Flat - B Key Plan



Flat - C

Super Built-up Area-911 Sq ft  
**2BHK**



Flat - C Key Plan



# Flat - D

Super Built-up Area-1098 Sq ft  
**2BHK**



Flat - D Key Plan





# Flat - E

Super Built-up Area-1105 Sq ft  
**2BHK**

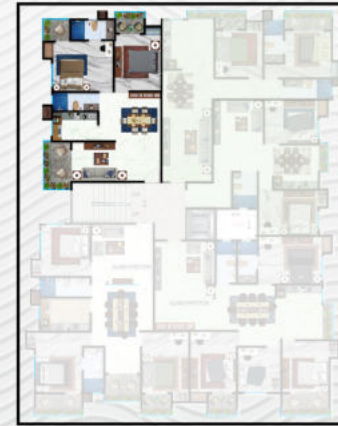

Flat - E Key Plan



# Side Day View

Crown Centelleo with a promising commitment to an exclusive lifestyle with superior interior and facilities at par international standards.



Side  
**Night View**



# Amenities



AC Community Hall

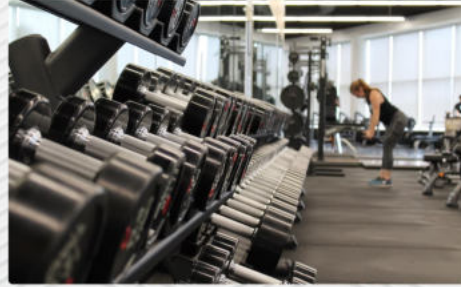

Gymnasium



Yoga Room



Water Treatment Plant



Video Door Phone



24 Hrs Power Supply



OTIS Lift



24/7 Security



CCTV Camera

# Specification

## FOUNDATION AND STRUCTURE

Structure and design followed by IS Code  
Foundation with 65 feet RCC pile and pile Cap.  
ACC cement or similar brand and branded steel.

## WALL

External Wall: 8" wall with no.1 brick/AAC block  
Internal Wall: 5" wall with no.1 brick/AAC block

## PLASTER/PUTTY/PAINT

External Wall: Water coated paint over plaster  
Internal Wall: Putty over plaster  
Ceiling: Putty over plaster

## LIFT LOBBY AND STAIR

Marble/Vitrified tiles with MS railing  
Lift Lobby: Putty with primer finish  
Stair: Guarded by steel railing

## DOOR/FRAME

Main Door: Designer door made by *Segun wood*  
Inside Door: Good quality Flush door  
Balcony Door: Sliding Glass door or Flush door.  
Toilet Door: Frame with PVC door

## BUILDING ENVELOP

Aesthetically design and painted with  
mix of texture/acrylic emulsion paint.

## TOILET

Floor: Anti skid ceramic tiles  
Wall: Ceramic tiles upto 7 feet height  
Water proofing on wall & floor  
Ceiling: Putty  
Geyser: Geyser point in all toilets  
Sanitary Ware : Good quality make  
CP Fitting : Good quality make



FOUNDATION  
AND STRUCTURE



LIFT LOBBY  
AND STAIR



PLASTER/PUTTY/PAINT



DOOR /FRAME



BUILDING ENVELOP



TOILET

## WINDOW

Aluminium & glass sliding window.

## FLOORING

Bed Room/Living/Dining : Vitrified tiles  
Balcony : Vitrified tiles as per design  
Lift lobby and stair: Marble/Vitrified tiles

## WATER SUPPLY

24 /7 Water Supply  
Water Treatment Plant.

## KITCHEN

24 /7 Water supply  
Wall: Ceramic tiles upto 2 feet height above the counter  
Ceiling: POP/Putty  
Counter: Black stone slab

## ELECTRICAL

Wire, Switch Board, Switches: Concealed copper wiring  
with finolex or similar quality wire. Modular switch  
25 nos point only.

## Air Conditioning

AC Point provision in all bed rooms.

## ROOF

Water proofing applied on rooftop.

## LIFT

OTIS or similar lift.

## OTHER FACILITIES

Dish TV connection in all bed rooms and telephone  
connection only on living room.



WINDOW



WATER SUPPLY



FLOORING



KITCHEN



ELECTRICAL



Air Conditioning

# Location Map



Please Scan for the **Location**

- 10 minutes to Dhakshineswar metro station
- 15 minutes drive to Belgharia Expressway
- 5 minutes walk to Ganga River
- 5 minutes to Konnagar Rail Station by toto
- 10 minutes drive to Delhi Road
- Markets, Schools, Colleges, Hospitals and Banks are in close vicinity

# ABOUT DEVELOPER

Crown Realty undoubtedly is number one real estate development company in Konnagar with strong focus on delivering high quality projects. We commenced operations in Konnagar in the year 2013 and have since expanded our presence in this area. Crown Realty has always lived upto the commitment they make to their customers. They provide comfortable, luxurious spaces which are not too hard on the pocket, as they believe in keeping their customers happy and contribute towards joyful living.

Crown Realty is known to deliver top quality projects in Konnagar like Pronit Apartment, Anuraj Apartment, Arjita Apartment, Kiran Villa, Crown Palace and Maya Enclave. Konnagar is well-connected to other parts of city by Metro, Rail line, road, which passes through the heart of this suburb. Prominent shopping malls, movie theatres, school, and hospitals are present in proximity of these residential projects.



✉ [rcrown.realty@gmail.com](mailto:rcrown.realty@gmail.com)

🌐 [www.crownrealty.in](http://www.crownrealty.in)



**CROWNREALTY**  
We deliver more than we commit  
BUILDERS & DEVELOPERS

📞 **Call : 98360 52595 / 79805 34431/ 98753 38028**

📍 358 Criper Road, Konnagar, Hooghly, WB - 712235

This is not a legal document. It describes the conceptual plan and intent of the builder. The images and details mentioned in this document are tentative and subject to change at the sole discretion of the developer and/or architects, internal door layout, car parking spaces and other specifications may change without notice